

NOTES

- NOTES
1. DETAILS AND SECTIONS SUBJECT TO FINAL DESIGN.

REFERENCE DRAWINGS

REV	DATE	DESCRIPTION	DRN	CHK	APP	CLT
D1	01/05/07	APPROV FOR PLANNING	PS			



SHANNON LNG



TITLE:
GENERAL ARRANGEMENT ELEVATION
200,000 CU.M LNG TANK LOW PROFILE

SCALE (A1): NOT TO SCALE

DOCUMENT ID:

CONTRACT No: 157793

CLIENT CONTRACT No:

DRAWING No.

157793-000-CV-DR-C201

DESCRIPTION	UNIT
WORKING CAPACITY	200,000 ³ m
FREBOARD ABOVE DESIGN LL	565 mm
PRODUCT DESIGN DENSITY (MAX)	487 kg/m ³
DESIGN TEMPERATURE (MIN.)	-170 deg C
MAX. UPSET PRES. (MAX "NORMAL")	290 mbarg (250 mbarg)
MINIMUM DESIGN PRESSURE	-5 mbarg
HYDRO. TEST LEVEL - INNER TANK	20600 mm
CORROSION ALLOWANCE	0 mm
DESIGN STANDARD-IN/OUTER TANK	BS7777 / BS8110
BOILOFF	0.05% per day

ITEM	MATERIAL SPECIFICATION	MATERIAL
INNER SHELL, INNER BOTTOM,		ASTM A553 TYPE 1
INNER ANNULAR PLATE		ASTM A553 TYPE 1
SUSPENDED DECK		ASTM B209 5083-0 (ALUM)
SECONDARY BOTTOM		ASTM A553 TYPE 1
OUTER SHELL (LINER)		S235J2G3
OUTER BOTTOM (LINER)		S235J2G3
ROOF (LINER)		S355J2G3
VERTICAL WALL LINER EMBEDMENTS		S235J2G3
HORIZ. WALL EMBEDMENTS AT TOP		ASTM A553 TYPE 1
THERMAL CORNER PROTECTION		ASTM A553 TYPE 1
SUSP. DECK RODS (UPPER PART)		CARBON STEEL
SUSP. DECK RODS (LOWER PART)		STAINLESS
ROOF STRUCTURAL		S355JR
CONCRETE STRENGTH (CUBE)		SLAB 40 MPa (CUBE)
		WALL & ROOF 50 MPa
		GRADE 460 (MPa)

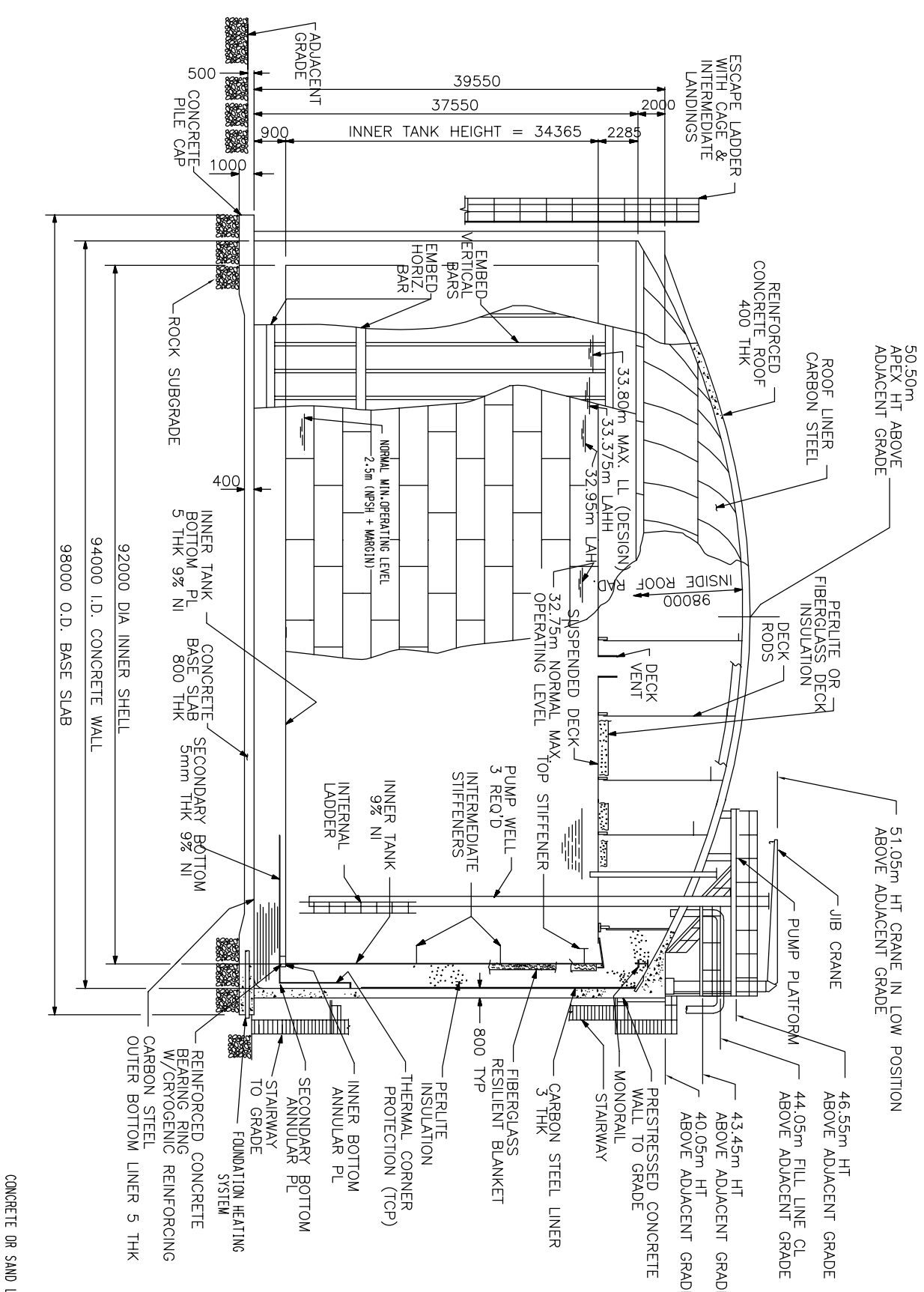

BOTTOM INSULATION SYSTEM

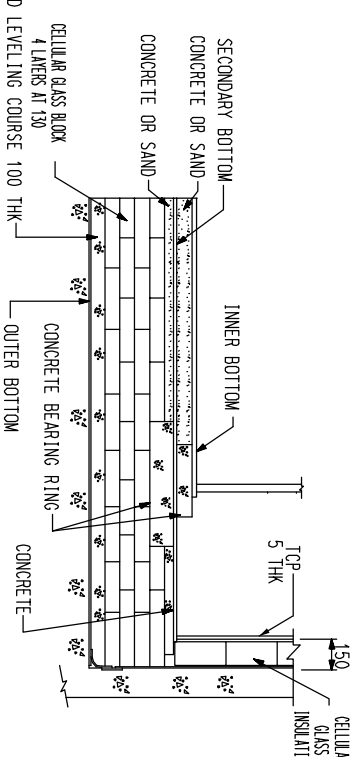

GENERAL ARRANGEMENT

(NOT TO SCALE)